

SOFFIT GENERAL NOTES:

1. NOMINAL 6mm CEMINTEL SOFFITLINE™ SHEET SHOWN - refer to manual for additional sheet options.
2. USG CEILING FRAMING SHOWN - refer to USG manual for span tables.
3. AS NOTED - refer Architects drawings and specifications.

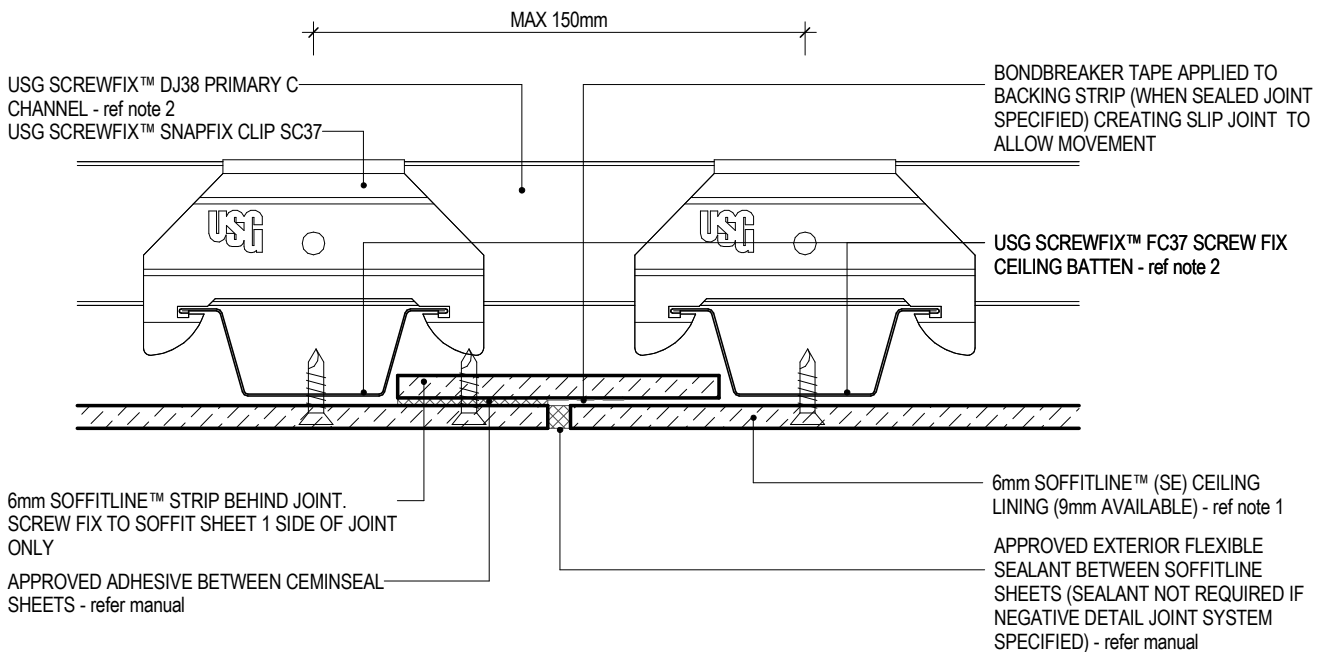

**CEMINTEL™ FIBRE CEMENT SYSTEMS - EXTERIOR CEILING SYSTEMS
SOFFIT JOINT DETAIL - SEALED (SCREWFIX SUSPENSION SYSTEM)
SECTION DETAIL**

C3.5.11
SHEET

1:2@A4
SCALE

0 18/07/12
ISSUED DATE

0800 POTTER (0800 768 837) WWW.POTTERS.CO.NZ
DETAILS SUBJECT TO CHANGE WITHOUT NOTICE

