

HERADESIGN® SYSTEM GENERAL NOTES:

1. NOMINAL 25mm HERADESIGN® SHEET SHOWN - 15mm sheet also available for ceiling use only. Refer to manual for additional sheet options.
2. CEILING FRAMING PIS (Potter Interior Systems) - refer to PIS technical manual for span tables. Hangers @ 1200 crs, Hera battens @ 400 crs for 15mm or @ 600 crs for 25mm sheet.
3. WALL FRAMING PIS Hera Wall Batten on adjustable clip fixings - refer to PIS technical manual. 25mm sheet only on Hera battens spaced @ 400 crs for impact.
4. AS NOTED - refer Architects drawings and specifications.

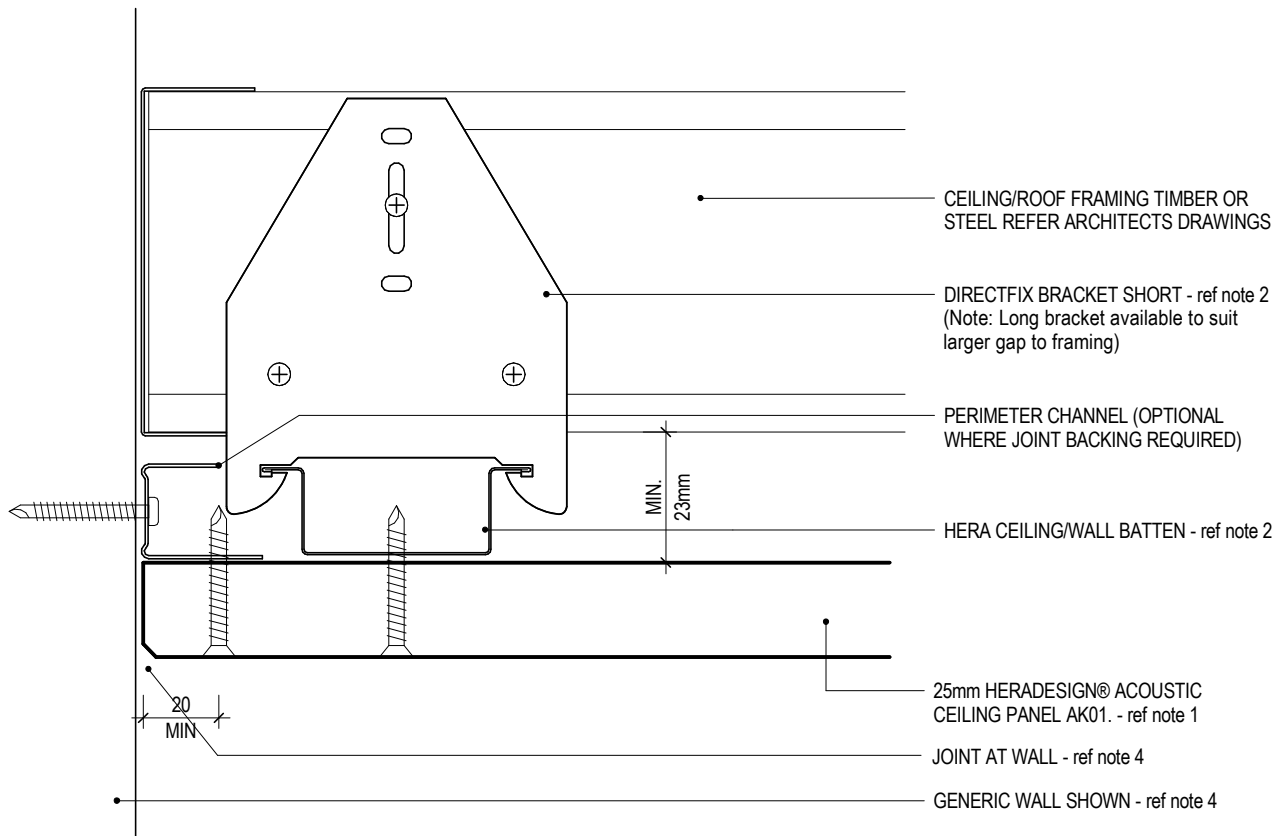

POTTER
INTERIOR SYSTEMS



HERADESIGN® SUSTAINABLE ACOUSTIC SOLUTIONS HERADESIGN® CEILING PERIMETER DETAIL (DIRECT FIX - CROSS DIRECTION) SECTION DETAIL

H2.3.2
SHEET

1:2@A4
SCALE

A 17/07/15
ISSUED DATE

0800 POTTER (0800 768 837) WWW.POTTERS.CO.NZ
DETAILS SUBJECT TO CHANGE WITHOUT NOTICE

CSR