

# Penopatch™

*The 30 Second Fire Seal*

*Flexible & versatile fire rated patch for fast treatment of small cables & pipe penetrations.*

*Approved to AS1530.4-2014 and BS EN 1366-3: 2009*



*Technical Data Sheet*

## KEY BENEFITS

- Low cost
- Fast 30 second installation
- Fire rated up to 60 minutes
- Simple to identify, audit & certify
- No curing time
- Versatile - use on a variety of services

## INTRODUCTION



**BOSS PenoPatch™** is a low cost, simple method of sealing blank openings, individual cables, small bundles of cables, pipes and conduits in a range of 1hr fire walls. Made with a fire resistant advanced formula putty with a

strong bonding capability, the **BOSS PenoPatch™** simply presses onto the wall around the service and instantly provides up to a 60 minute fire rating.

**BOSS PenoPatch™** is supplied in the form of a 60mm diameter discs in packs of 20 units. (100mm Diameter **BOSS PenoPatch™** is also available upon request. Contact the BOSS office for minimum order quantities).

The **BOSS PenoPatch™** has been tested to various international standards including AS1530.4-2014 and BS EN1366-3: 2009. It has been tested on some of the most onerous conditions including single layer plasterboard systems. Under fire conditions the product maintains its bond to the substrate. The integrity and insulation is then maintained by the stability of the remaining product char.



Ideal for Electricians, Plumbers & Gasfitters, HVAC&R installers, maintenance personnel and passive fire applicators.

## PRODUCT APPLICATIONS & ADVANTAGES

- Up to 16mm Dia. Pipes including:
  - Combustible pipes
  - Combustible Conduits
  - PEX Pipe
  - Steel & Copper Pipes
- Data Cables
- Power Cables such as TPS
- Small Cable Bundles
- Blank Openings
- Suitable for use in new and existing builds
- The most simple installation method available
- No mess - no clean up
- Ease of certification
- Approved on a wide range of substrates including plasterboard, masonry and concrete walls.

## PHYSICAL PROPERTIES

Description	Advanced Formula FR Putty
Size	60mm Dia. x 4mm Thick 100mm Dia. x 4mm Thick
Density	1.55-1.6g/cm <sup>3</sup>
Colour	Green
Application temperature	+5°C
Box Quantity	20
Expected Shelf Life	12 Months (Store unopened in dry conditions).
Testing	AS1530.4-2014, BS EN1366-2009

## INSTALLATION

- Ensure the aperture and services in question are tested or assessed with **BOSS PenoPatch™**, and site conditions are within the application specification.
- Ensure your aperture size meets with the appropriate tested solution.
- All services and apertures need to be thoroughly cleaned and free of dust and debris or loose particles.

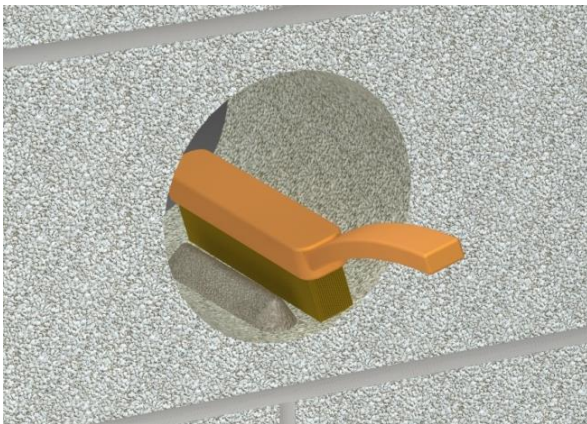

- The aperture needs to be at 5°C or above at time of installation.
- Simply peel off the backing paper, exposing the tacky rear face of the **BOSS PenoPatch™**.
- Ensure the **BOSS PenoPatch™** will be applied with the slot facing down towards the floor.
- Apply the **BOSS PenoPatch™** around the service and press firmly with fingers moulding the **BOSS PenoPatch™** to fully encircle the service and adhere to the wall surface. Maintain pressure for a period of 30 seconds to ensure correct bond.

**COMMON CONSTRUCTION DETAILS**

**PEX Pipe up to 16mm Ø:**

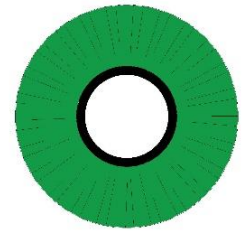
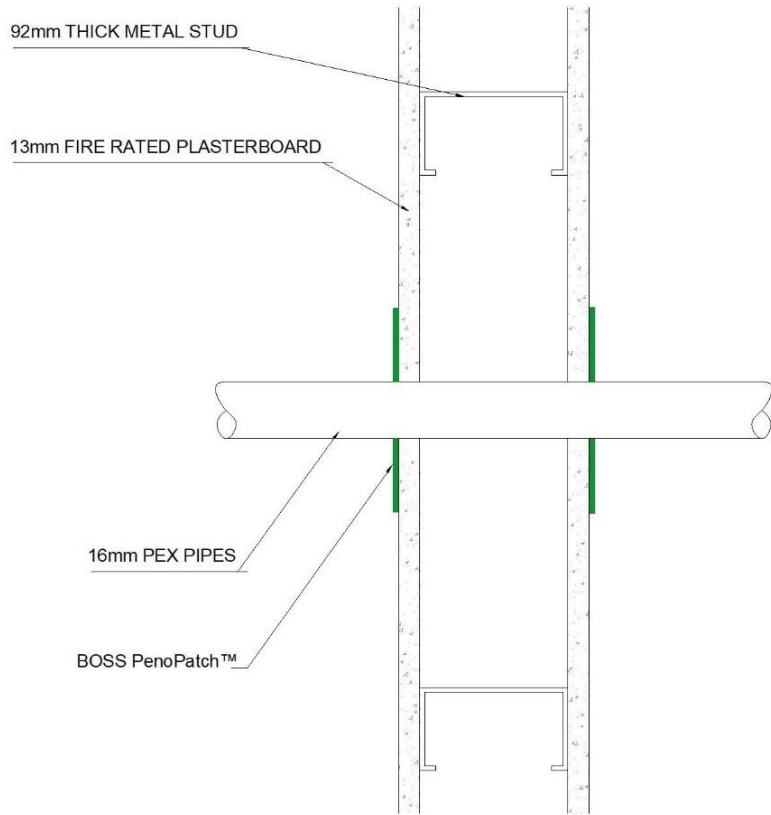

**CAT6 Data Cables:**

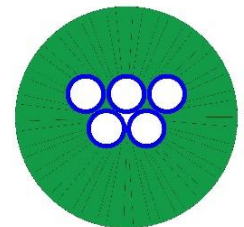
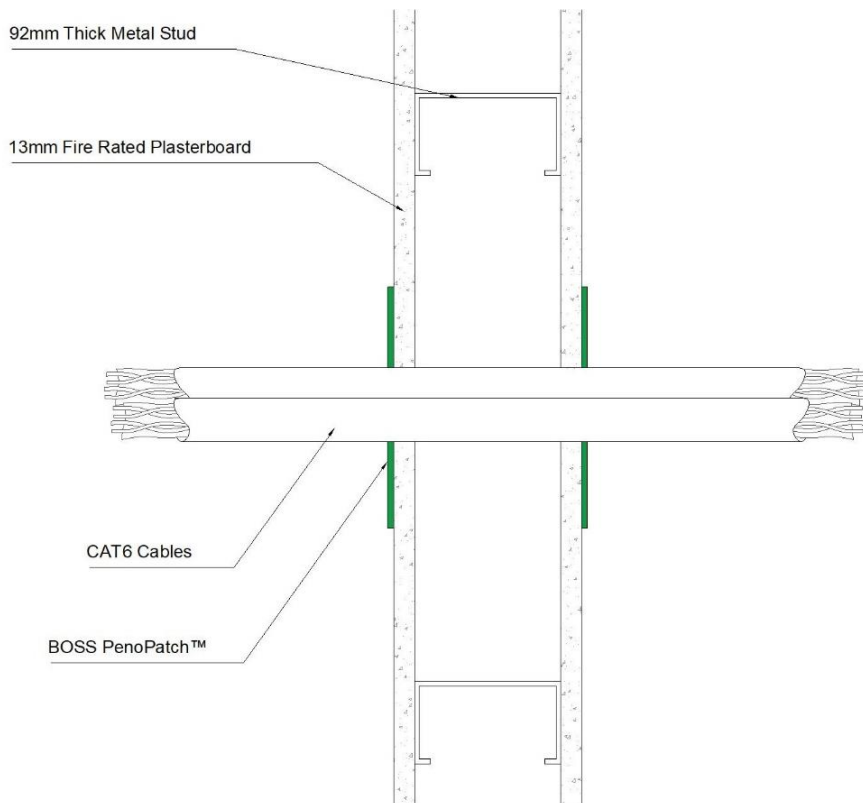

**COMMON CONSTRUCTION DETAILS CONTINUED....**

**TPS Power Cables:**

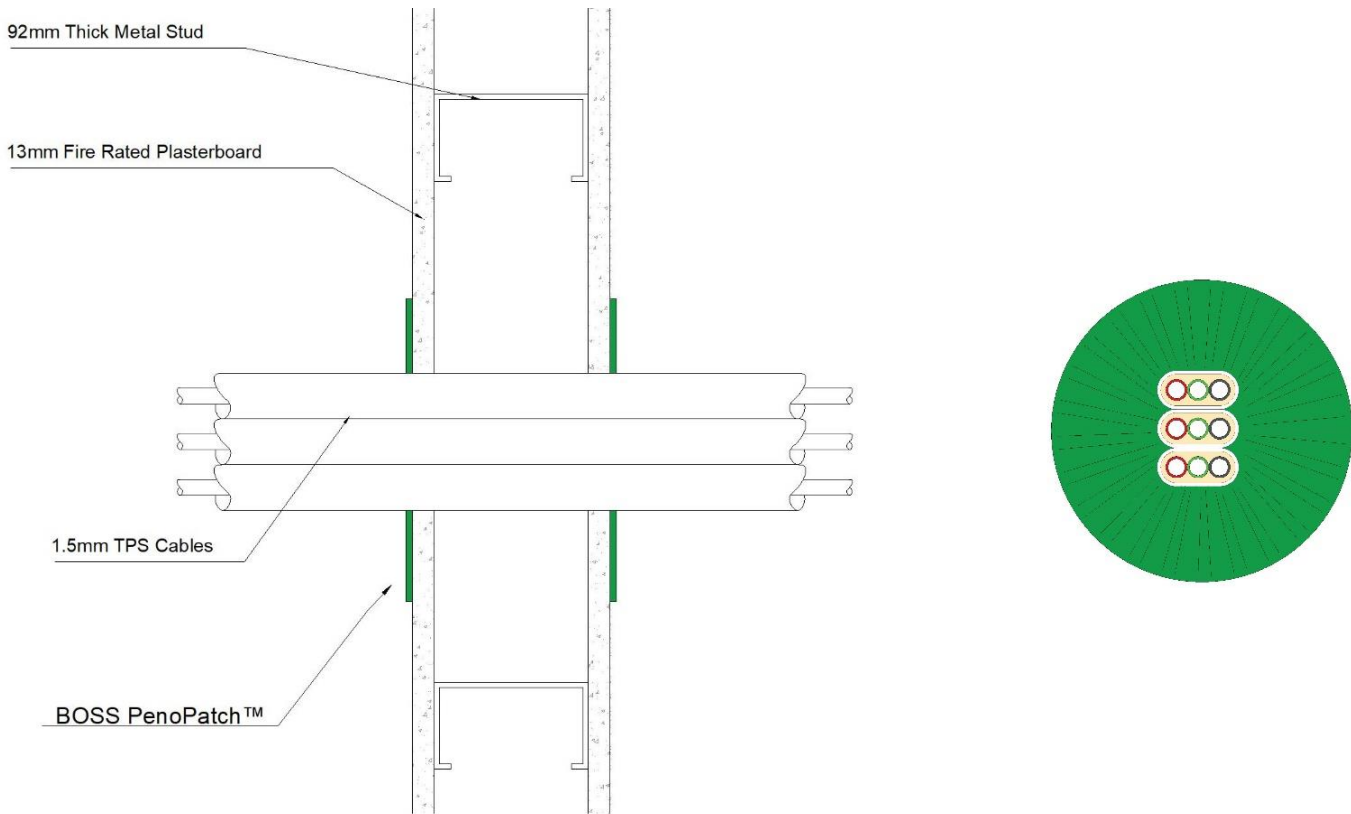

**APPROVED APPLICATIONS**

Approved to AS1530.4-2014 by WarringtonFire

Service	Local Fire Stopping Protection System	Wall Type	Seal Size	FRL
---------	---------------------------------------	-----------	-----------	-----

**60min Wall System:**

16mm Ø PEX Pipe	<b>Boss Penopatch™</b> - 60mm Dia.	118mm Single Layer Plasterboard Wall	20mm Ø Aperture 2mm Annular Gap	-/60/60
Bundle of CAT6 Data cables (5 of)	<b>Boss Penopatch™</b> - 60mm Dia.	118mm Single Layer Plasterboard Wall	20mm Ø Aperture 5mm Annular Gap	-/60/30
Bundle of TPS Power Cables (3 of)	<b>Boss Penopatch™</b> - 60mm Dia.	118mm Single Layer Plasterboard Wall	20mm Ø Aperture 5mm Annular Gap	-/60/60

Approved to BS EN 1366-3: 2009 by WarringtonFire

Service	Local Fire Stopping Protection System	Wall Type	Seal Size	FRL
---------	---------------------------------------	-----------	-----------	-----

**60min Wall System:**

Blank Seal	<b>Boss Penopatch™</b> - 60mm Dia.	100mm Double Layer Plasterboard Wall	25mm x 25mm Aperture	-/60/60
Single PVC / PVC Sheathed 5mm x 1.5mm <sup>2</sup> Cable	<b>Boss Penopatch™</b> - 60mm Dia.	100mm Double Layer Plasterboard Wall	25mm x 25mm Aperture	-/60/30
Single EPR / PO Sheathed 5mm x 1.5mm <sup>2</sup> Cable	<b>Boss Penopatch™</b> - 60mm Dia.	100mm Double Layer Plasterboard Wall	25mm x 25mm Aperture	-/60/30
Single XLPE /EVA Sheathed 5mm x 1.5mm <sup>2</sup> Cable	<b>Boss Penopatch™</b> - 60mm Dia.	100mm Double Layer Plasterboard Wall	25mm x 25mm Aperture	-/60/60
Single PVC / PVC Sheathed 4mm x 95mm <sup>2</sup> Cable	<b>Boss Penopatch™</b> - 60mm Dia.	100mm Double Layer Plasterboard Wall	25mm x 25mm Aperture	-/60/30
Steel or Copper Pipe up to 16mm Dia.	<b>Boss Penopatch™</b> - 60mm Dia.	100mm Double Layer Plasterboard Wall	25mm x 25mm Aperture	-/60/30
PVC Conduit up to 16mm Dia.	<b>Boss Penopatch™</b> - 60mm Dia.	100mm Double Layer Plasterboard Wall	25mm x 25mm Aperture	-/60/60
Single PVC / PVC Sheathed 1mm x 185mm <sup>2</sup> Cable	<b>Boss Penopatch™</b> - 60mm Dia.	100mm Double Layer Plasterboard Wall	25mm x 25mm Aperture	-/60/30

Bundle of 3 PVC / PVC Sheathed 5mm x 1.5mm <sup>2</sup> Cables	<b>Boss Penopatch™</b> - 100mm Dia.	100mm Double Layer Plasterboard Wall	50mm x 50mm Aperture	-/60/60
Bundle of 3 EPR / PO Sheathed 5mm x 1.5mm <sup>2</sup> Cables	<b>Boss Penopatch™</b> - 100mm Dia.	100mm Double Layer Plasterboard Wall	50mm x 50mm Aperture	-/60/30
Bundle of 3 XLPE /EVA Sheathed 5mm x 1.5mm <sup>2</sup> Cables	<b>Boss Penopatch™</b> - 100mm Dia.	100mm Double Layer Plasterboard Wall	50mm x 50mm Aperture	-/60/60
Single PVC / PVC Sheathed 4mm x 95mm <sup>2</sup> Cable	<b>Boss Penopatch™</b> - 100mm Dia.	100mm Double Layer Plasterboard Wall	50mm x 50mm Aperture	-/60/30
Blank Seal	<b>Boss Penopatch™</b> - 100mm Dia.	100mm Double Layer Plasterboard Wall	50mm x 50mm Aperture	-/60/60
Steel or Copper Pipe up to 16mm Dia.	<b>Boss Penopatch™</b> - 100mm Dia.	100mm Double Layer Plasterboard Wall	50mm x 50mm Aperture	-/60/-
PVC Conduit up to 16mm Dia.	<b>Boss Penopatch™</b> - 100mm Dia.	100mm Double Layer Plasterboard Wall	50mm x 50mm Aperture	-/60/30
Single PVC / PVC Sheathed 1mm x 185mm <sup>2</sup> Cable	<b>Boss Penopatch™</b> - 100mm Dia.	100mm Double Layer Plasterboard Wall	50mm x 50mm Aperture	-/30/30

## HEALTH AND SAFETY

To learn more about the safe handling of **BOSS Penopatch™**, see the Safety Data Sheet available at [bossfire.com](http://bossfire.com).

## LIMITATION

BOSS Fire & Safety Pty Ltd has provided the above technical information in good faith and to be best of its knowledge. This information was deemed to be correct at the time of publication. Should any data come to BOSS Fire & Safety's attention relating to the fire resistance or performance of the product described, BOSS Fire & Safety reserve the right to amend this report.

BOSS Fire & Safety strive to constantly improve and developed products so this information may change without notice.

## FURTHER TECHNICAL INFORMATION

For additional technical information on the performance of **BOSS Penopatch™** or other BOSS products please contact our Technical Services team on:

**Phone 1300 50 BOSS**

Fax 1300 60 BOSS

Direct +612 9531 8591

Email [info@bossfire.com.au](mailto:info@bossfire.com.au)

Web [bossfire.com](http://bossfire.com)

**NZ 0800 50 BOSS**

[bossfire.co.nz](http://bossfire.co.nz)