

NOTE:
CEILING TILE ACCESS ZONE IS
WITHIN CONSTRUCTION DEPTH

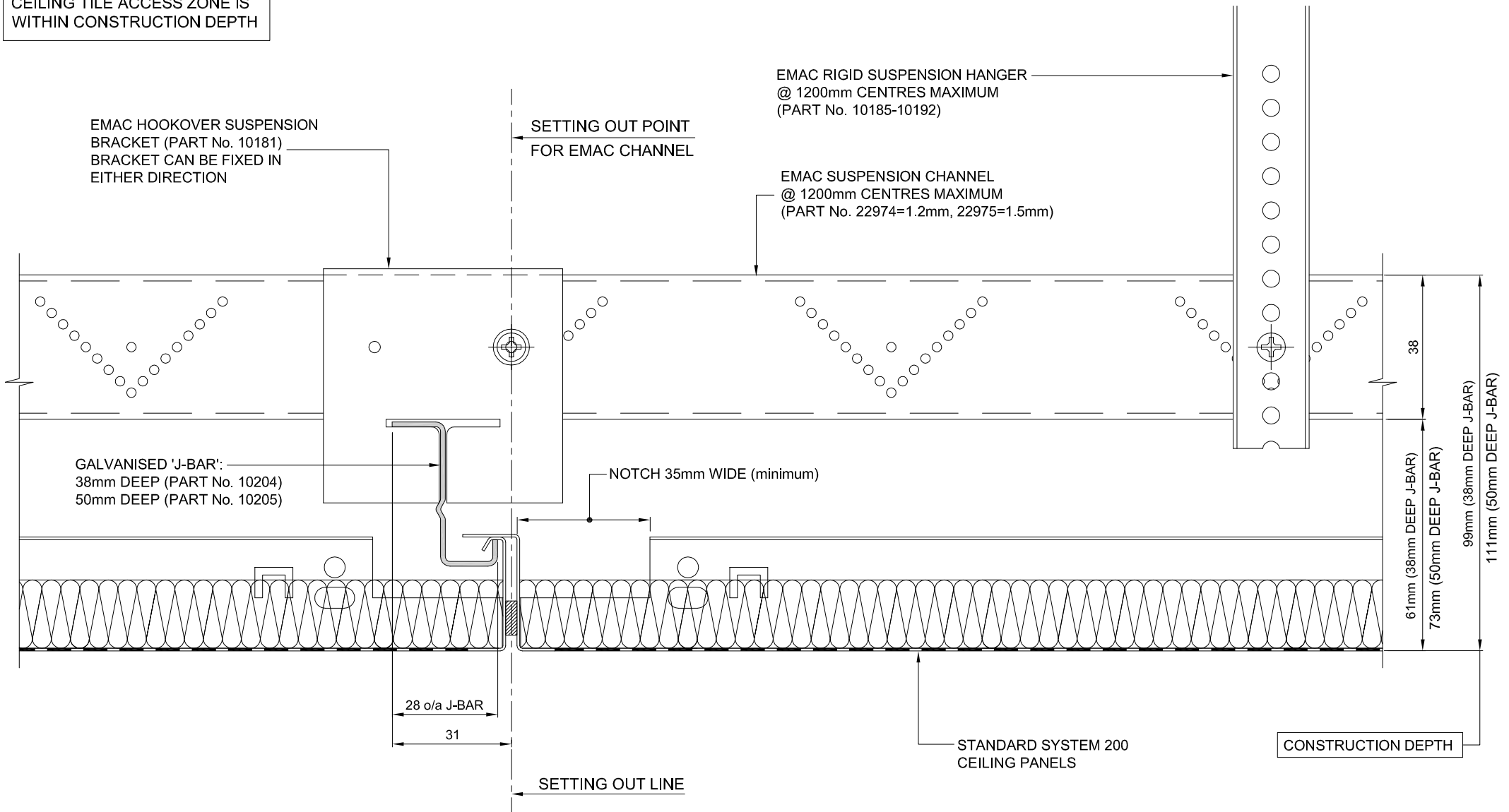

PANEL TO BE REMOVED

STEP 1

LIFT ADJACENT PANEL TO PANEL BEING REMOVED

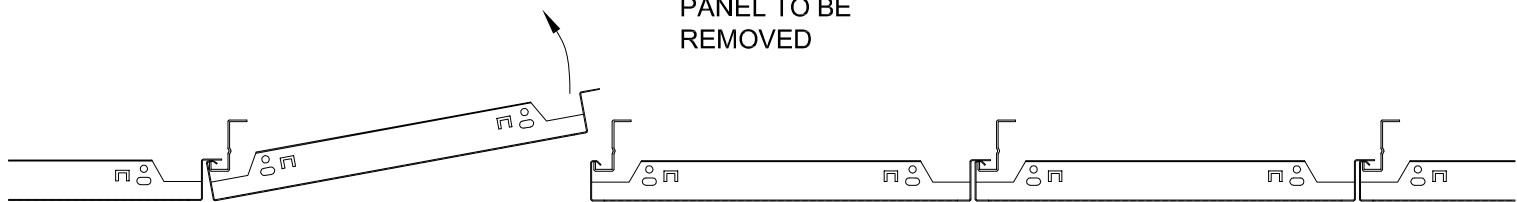

STEP 2

LIFT ACCESS PANEL AND UNHOOK FROM GRID

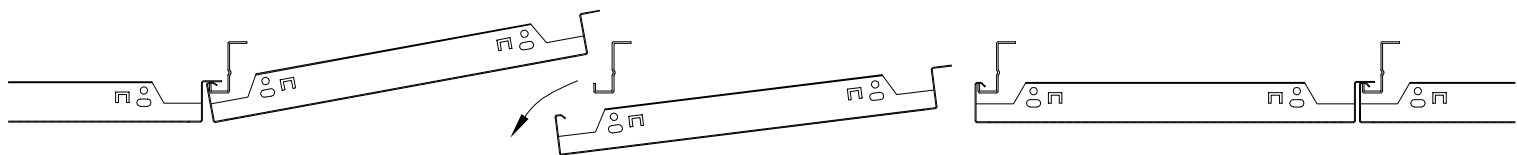

STEP 3

REMOVE ACCESS PANEL AND ALLOW ADJACENT PANEL TO DROP BACK

